

Great Peconic Bay

N

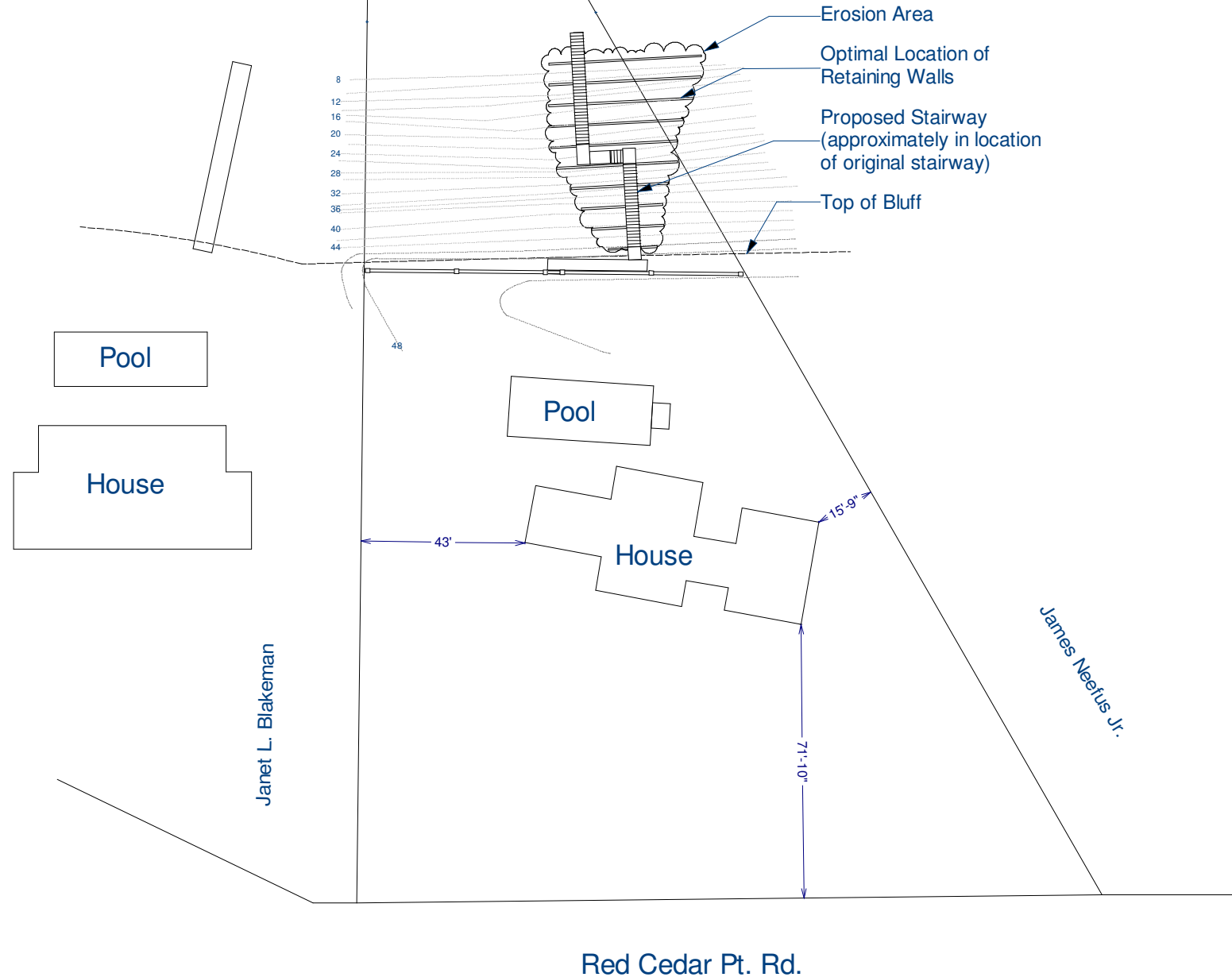

Site Plan with Proposed Retaining Walls

Scale: 1" = 40'

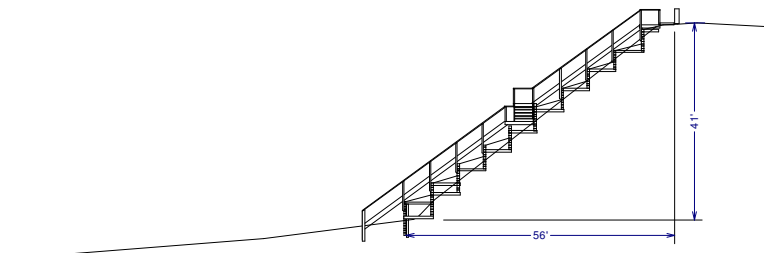

Section

Scale: 1" = 40'

Varano Residence
Hampton Bays

Beach Stairs

Copyright (c) 2013. All rights reserved.
Webb Builders, Inc.
Design, Drafting, Engineering,
General Contracting
516 - 982 - 8502

Site Plan	Date	Drawn by	Scale	Sheet
	2/18/13	DW		1

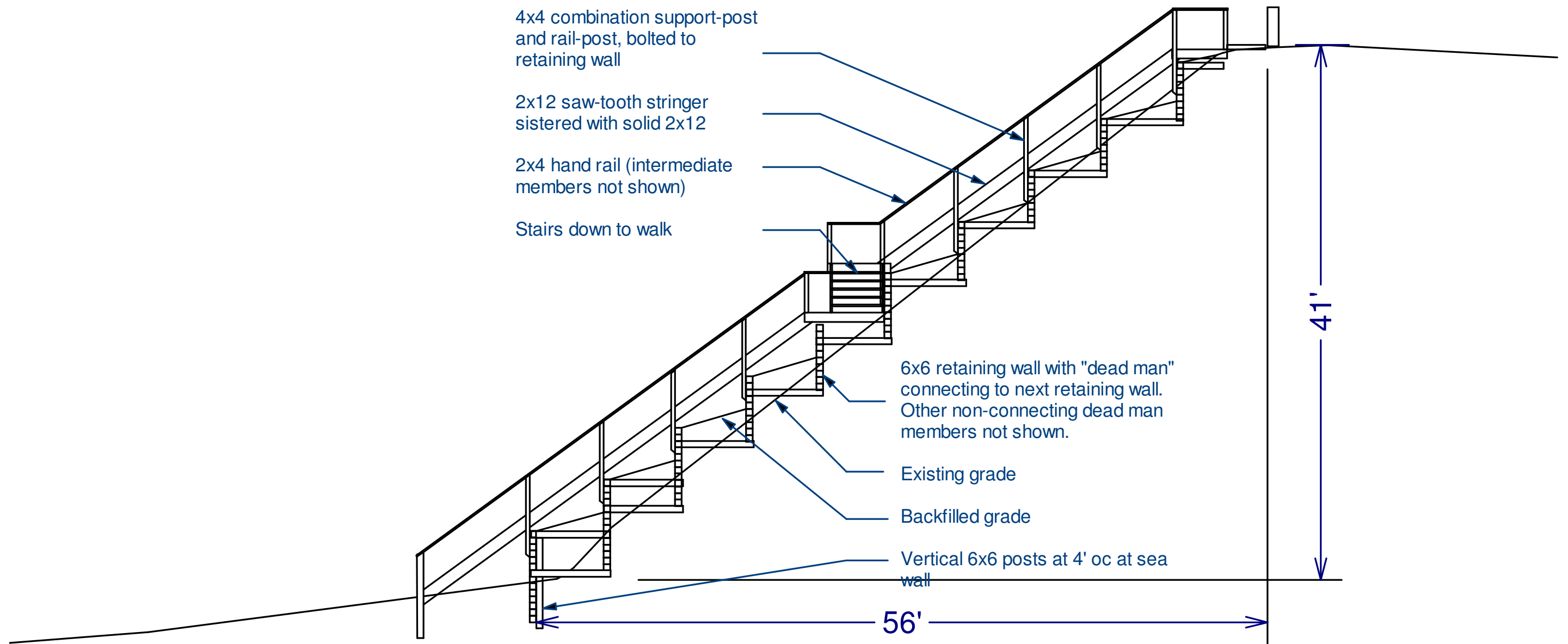

Retaining Wall and Stair Section

Scale: 1/8" = 1'

<p>Varano Residence Hampton Bays</p> <p>Beach Stairs</p>	<p>Copyright (c) 2013. All rights reserved.</p> <p>Webb Builders, Inc. Design, Drafting, Engineering, General Contracting 516 - 982 - 8502</p>			
	<p>Date</p> <p>2/18/13</p>	<p>Drawn by</p> <p>DW</p>	<p>Scale</p>	<p>Sheet</p> <p>2</p>
<p>Retaining Wall Section</p>				

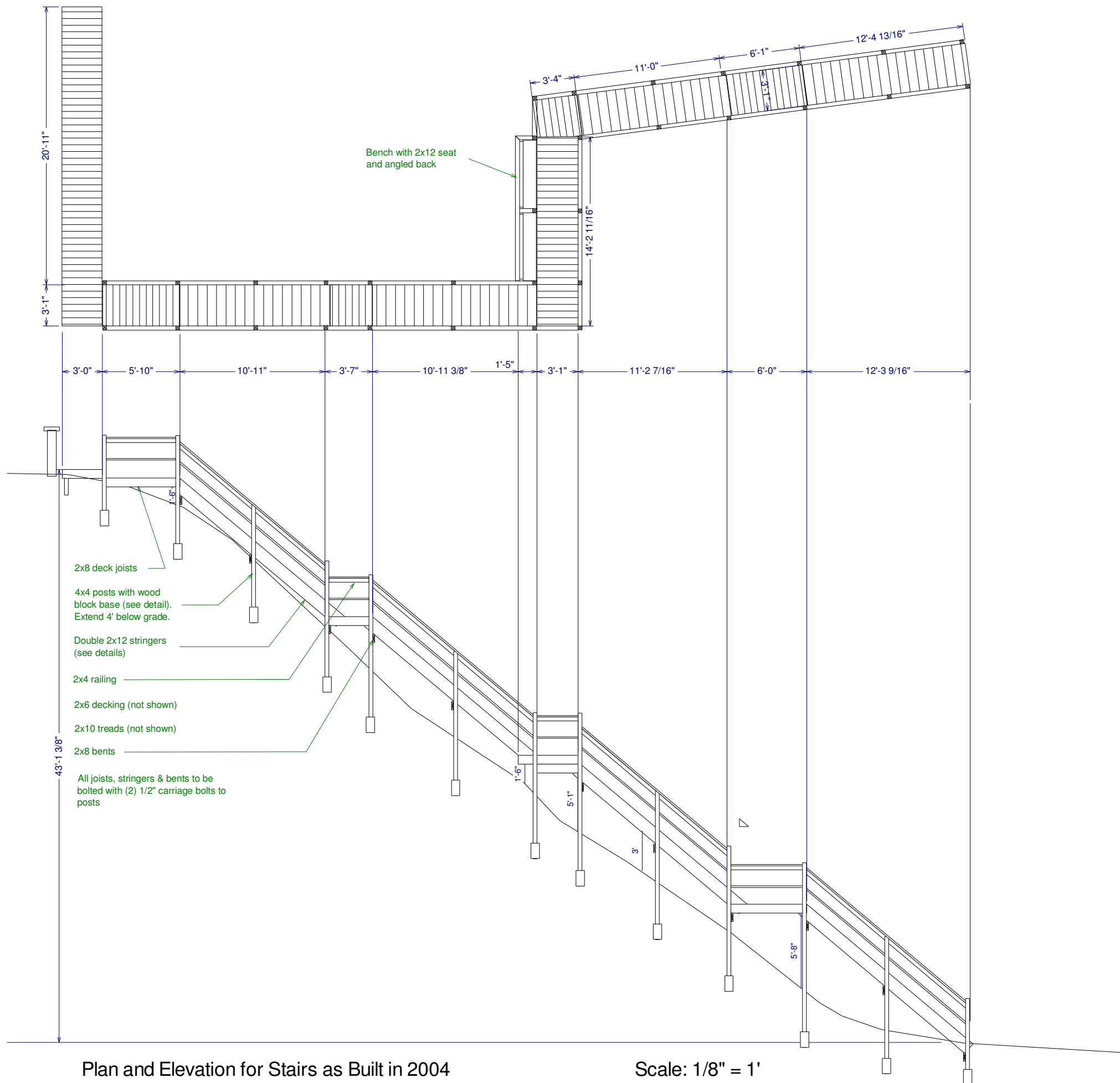

Plan and Elevation for Stairs as Built in 2004

Scale: 1/8" = 1'

Varano Residence Hampton Bays Beach Stairs	<small>Copyright (c) 2013. All rights reserved.</small> Webb Builders, Inc. Design, Drafting, Engineering, General Contracting 516 - 982 - 8502			
	Date	Drawn by	Scale	Sheet
2004 Stairs	2/18/13	DW		3

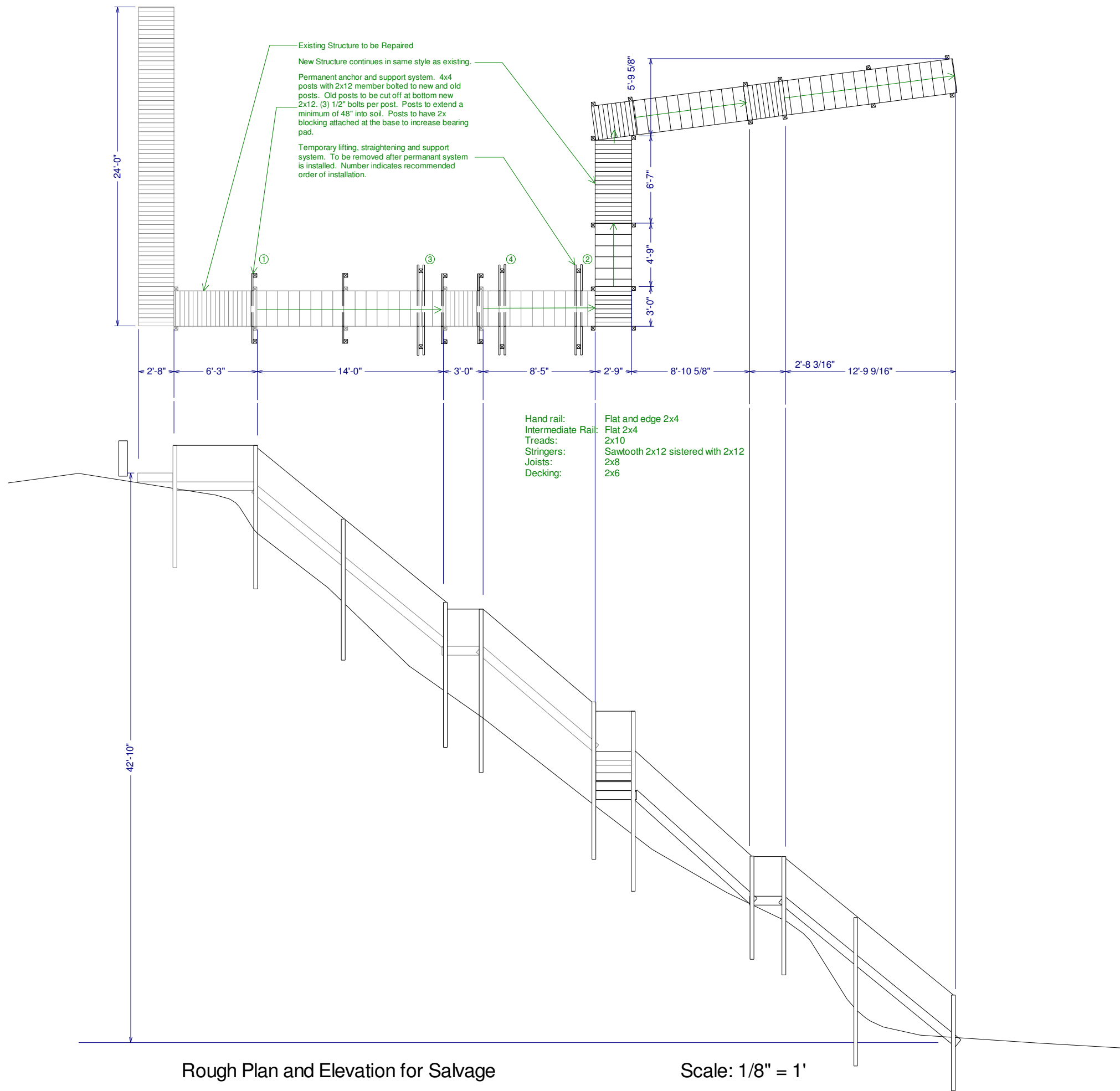

Rough Plan and Elevation for Salvage

Scale: 1/8" = 1'

<p>Varano Residence Hampton Bays</p> <p>Beach Stairs</p>	<p>Copyright (c) 2013, All rights reserved.</p> <p>Webb Builders, Inc. Design, Drafting, Engineering, General Contracting 516 - 982 - 8502</p>			
	<p>Date</p> <p>2/18/13</p>	<p>Drawn by</p> <p>DW</p>	<p>Scale</p>	<p>Sheet</p> <p>4</p>
<p>Alternate Salvage Plan</p>				

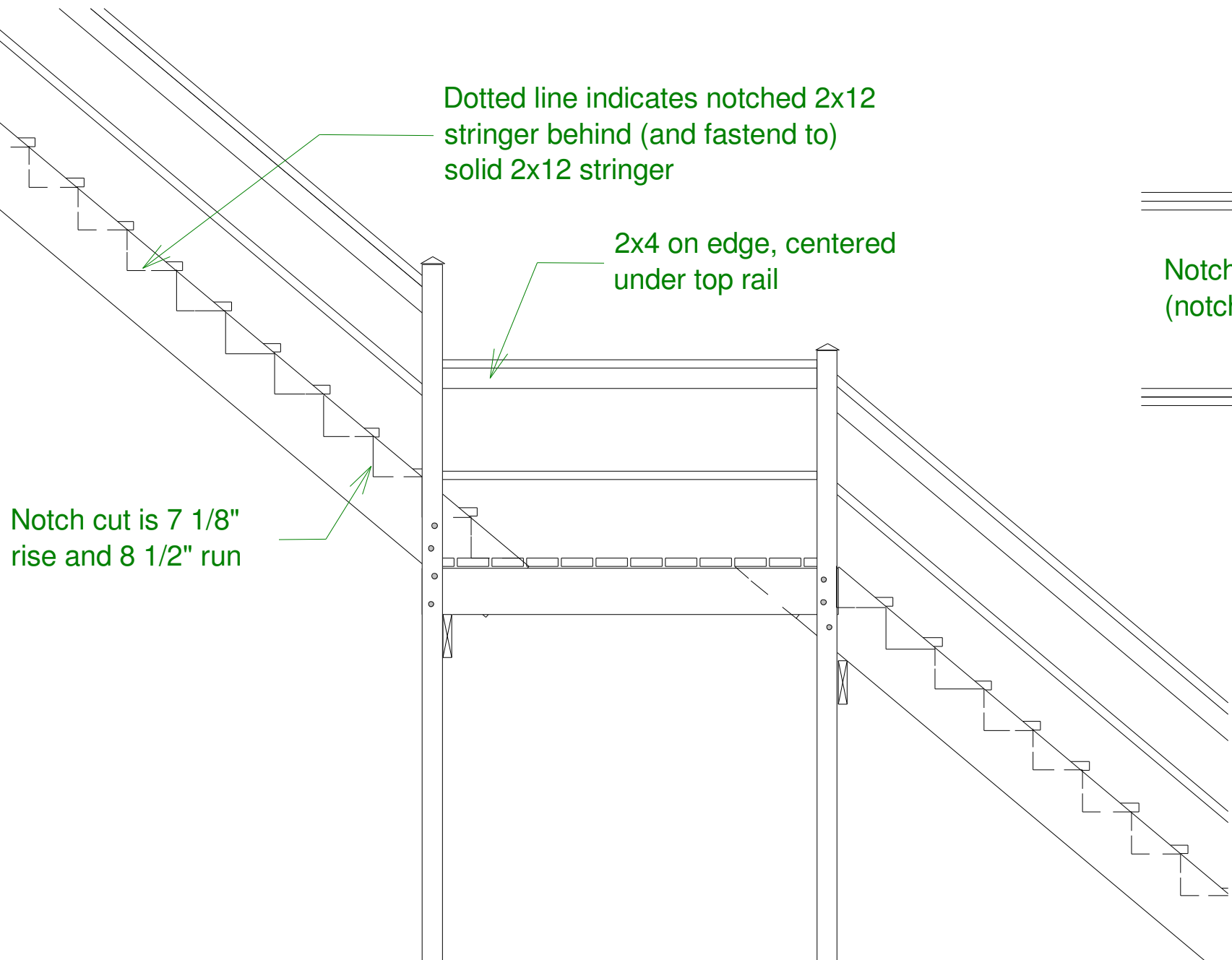

Detail A

Scale: 1/2" = 1'

Dotted line indicates notched 2x12 stringer behind (and fastend to) solid 2x12 stringer

2x4 on edge, centered under top rail

Notch cut is 7 1/8" rise and 8 1/2" run

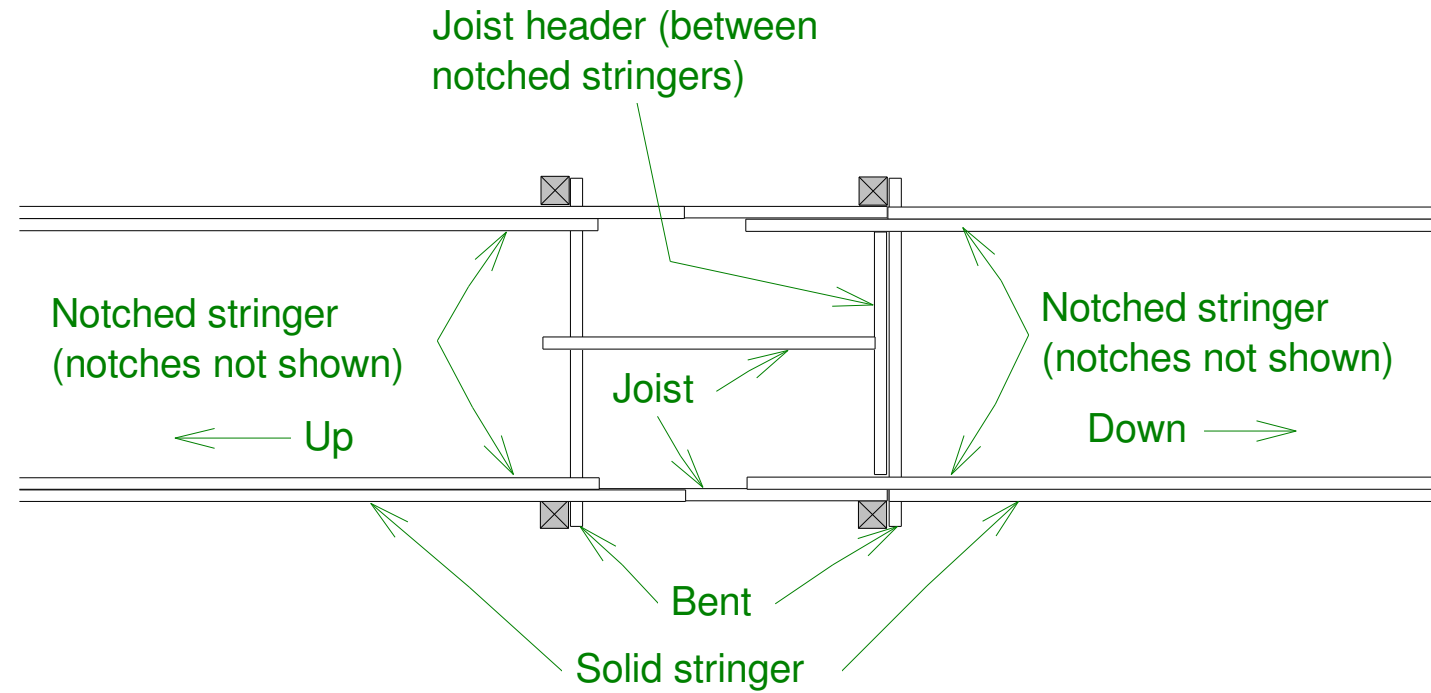

Detail C

Scale: 1/2" = 1'

Joist header (between notched stringers)

Notched stringer (notches not shown)

Notched stringer (notches not shown)

Joist

← Up

Down →

Bent

Solid stringer

Post bottom with (2) 16" 2x4 and (2) 16" 2x6 blocks attached.

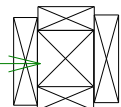

Detail B

Scale: 1" = 1'

<p>Varano Residence Hampton Bays</p> <p>Beach Stairs</p>	<small>Copyright (c) 2013, All rights reserved.</small> Webb Builders, Inc. Design, Drafting, Engineering, General Contracting 516 - 982 - 8502			
	<p>Date</p> <p>2/18/13</p>	<p>Drawn by</p> <p>DW</p>	<p>Scale</p>	<p>Sheet</p> <p>5</p>
<p>Framing Details</p>				